

FOREO
SWEDEN



FLIP™ plus

LED DETANGLING HAIRBRUSH



[ONLINE MANUAL](#)

FULL USER MANUAL

GETTING STARTED

Congratulations on discovering smarter hair care with FLIP™ plus LED detangling hairbrush. Before you begin to enjoy all the benefits of sophisticated technology in the comfort of your home, please take a few moments to carefully read the instructions in this manual.

Please READ ALL INSTRUCTIONS BEFORE USE and utilize this product only for its intended use as described in this manual.

⚠ WARNING: NO MODIFICATION OF THIS EQUIPMENT IS ALLOWED.

FLIP™ plus LED DETANGLING HAIRBRUSH OVERVIEW

Introducing the revolutionary LED hairbrush designed to improve hair and scalp health. Engineered with DualFlex™ bristles to detangle without snagging, and 76 LEDs to support your natural hair cycle - helping to reduce breakage & thinning.

Near-Infrared & Red light help revitalize follicles to boost thicker, healthier, fuller-looking hair. Blue light helps reduce excess oil & buildup for a more balanced scalp. Green light helps support scalp & follicle health for overall hair vitality. Designed for all hair types - straight, curly, thick, fine, or anywhere in between.

GETTING TO KNOW FLIP™ plus LED DETANGLING HAIRBRUSH

DUALFLEX™ BRISTLES

Anti-static bristles, adapt as you brush - flat side glides smoothly through lengths, narrow side eases through knots with a controlled resistance.

LED LIGHT THERAPY

NIR+Red light strengthens hair, Blue light balances scalp, and Green light supports natural hair cycle to combat hair loss.



UNIVERSAL POWER BUTTON

Turns device on and off, switches between LED colors, and puts device in Bluetooth pairing mode.

INDICATOR LIGHT

Flashes to indicate when device is in Bluetooth pairing mode, Smart Control mode, and when device needs to be charged.

USB CHARGING PORT

100% waterproof. Up to 2 hours of use per charge, with included USB charging cable.

OUTER FRAME

Flips forward to shield bristles from picking up lint or getting tangled in your bag. Flips back to open up bristles, ready to brush and repair your hair.

HOW TO USE FLIP™ plus LED DETANGLING HAIRBRUSH

UNLOCK YOUR DEVICE

Before using your device for the first time, you must unlock it. You can do this automatically by registering it via the FOREO app.

1. Download the FOREO For You app on your mobile phone by scanning the QR code.
2. Log in to your existing account, or sign up for a new one.
3. Add device (on the top of your screen).
4. Choose the device series.
5. Follow the instructions on the app and fill in the purchase information.

And your FLIP™ plus hairbrush is ready to use!

www.foreo.com/app



HOW TO USE



TURN ON

Flip open your FLIP™ plus hairbrush, and press the universal button to turn on the LED light.



SELECT LED

Press the universal button again to switch between LED light colors: red LED, green LED or blue LED.



BRUSH

Brush hair as normal, from scalp to ends of hair. Once finished, press the universal button for 3 seconds to turn the LED light off

TIPS:

- Apply FOREO's FLIP™ hair SPRITZ & SHIELD Detangling Spray before brushing to detangle knotted hair more easily, boost shine, or protect strands before heat styling.
- Access more settings for your FLIP™ plus hairbrush via the FOREO For You app.

WARNINGS

FOR OPTIMUM SAFETY:

- Brushing your hair with FLIP™ plus LED detangling hairbrush should be comfortable – if you experience any discomfort, discontinue use immediately and consult a physician.
- If taking a photosensitizing medication or herbal remedy, seek medical advice prior to application of the appliance as use may harm the skin.
- Do not stare directly at the LED lights.
- This appliance is not intended for the treatment of medical conditions. Medical advice should be sought to address, for example, moles, skin rash, itchy skin, skin fungus or infection, skin bumps, or skin tags; a list of possible side effects, including blistering, pain, and scarring.
- This product should not be used by children. Close supervision is necessary when this product is used by, on, or near children and those with reduced physical and mental abilities.
- For reasons of hygiene, we do not recommend sharing your device with anyone else.
- Avoid leaving your device in direct sunlight and never expose it to extreme heat or boiling water.
- Discontinue use if this product appears damaged in any way.
- This product contains no serviceable parts.
- Do not tamper or attempt to disassemble the product as this may cause damage to the unit.
- Do not use while driving or operating heavy machinery.
- Do not insert any object into any opening of the device.
- Do not use the device if it is overheating or you suspect that it is malfunctioning.
- This device should only be used with a SELV power adapter.
- Before charging, make sure that the plug and socket are completely dry. Failure to do so may result in electric shock, short circuit, or fire.
- Do not use the device while charging. Discontinue use if this device or charger is not working properly or appears damaged in any way. Only use the power cord supplied with your device.
- The device contains a non-replaceable battery. The battery must be removed from the appliance before it is disposed of. The appliance must be disconnected from the supply mains when removing the battery, and the battery is to be disposed of safely.
- Use this device only for its intended use as described in this manual. If you do not find the answer to your specific question, or if you have any other questions regarding the device's operation, please visit foreo.com/support.

CLEANING YOUR FLIP™ plus LED DETANGLING HAIRBRUSH

We recommend cleaning your FLIP™ plus hairbrush once a week. Wash the brush surface with water and soap, then rinse with warm water. Pat dry with a lint-free cloth or towel.

NOTE: Never use cleaning products containing alcohol, petrol, or acetone, as they may irritate the scalp and damage the silicone.

TROUBLESHOOTING

Precautions to be taken in the event of changes in the performance of your FLIP™ plus LED Detangling Hairbrush:

If your FLIP™ plus hairbrush cannot be switched on/off, and the universal button does not respond:

- If this is your first time using your FLIP™ plus hairbrush, it's locked. Follow the UNLOCK YOUR DEVICE instructions under the How To Use section of this manual.
- Battery is empty. Recharge using the USB charging cable for up to 1.5 hours until fully charged, and then restart your device by pressing the universal button.
- Microprocessor is temporarily malfunctioning. Press and hold the universal button to restart the device.

If your FLIP™ plus hairbrush won't sync to the FOREO app:

- Ensure that your FLIP™ plus hairbrush is fully charged, and that your Bluetooth is turned on.
- Switch your Bluetooth off and then on again to try reconnecting.
- Close the FOREO app and then reopen it to restart the process.
- The app may need to be updated. Delete and reinstall the app, then make sure to restart your phone.
- Delete your phone's cookies and cache memory.

WARRANTY TERMS & CONDITIONS

REGISTER WARRANTY

To activate your 2-Year Limited Warranty, register through the FOREO For You app, or visit foreo.com/product-registration for more information.

2-YEAR LIMITED WARRANTY

FOREO warrants this device for a period of TWO (2) YEARS after the original date of purchase against defects due to faulty workmanship or materials arising from Normal Use of the device. The warranty covers working parts that affect the function of the device. It does NOT cover cosmetic deterioration caused by fair wear and tear, or damage caused by accident, misuse or neglect. Any attempt to open or take apart the device (or its accessories) will void the warranty.

If you discover a defect and notify FOREO during the warranty period, FOREO will, at its discretion, replace the device free of charge. Claims under warranty must be supported by reasonable evidence that the date of the claim is within the warranty period. To validate your warranty, please keep your original purchase receipt together with these warranty conditions for the duration of the warranty period.

To claim your warranty, you must log in to your account at www.foreo.com and then select the option to make a warranty claim. Shipping costs are nonrefundable. This undertaking is in addition to your statutory rights as a consumer and does not affect those rights in any way.

DISPOSAL INFORMATION

Disposal of old electronic equipment (applicable in the EU and other European countries with separate waste collection systems).



This device should not be treated as household waste, but rather be brought to the appropriate collection point for recycling of electrical and electronic equipment. By ensuring this device is disposed of correctly, you will help prevent the potential negative consequences for the environment and human health which could be caused by inappropriate waste handling of the device. The recycling of materials will also help conserve natural resources.

For more information about the recycling of your device, please contact your local household waste disposal service or your place of purchase.

BATTERY REMOVAL

NOTE: This process is not reversible. This action must only be undertaken when the device is ready to be disposed of.

Because this device contains a lithium-ion battery, the battery must be removed before disposal and should not be thrown away with household waste. In order to do this, remove the silicone outer layer, open the inner plastic shell, remove the battery, and dispose of it in accordance with your local environmental regulations. Wear gloves during this process for your safety. Detailed visual instructions are provided below:

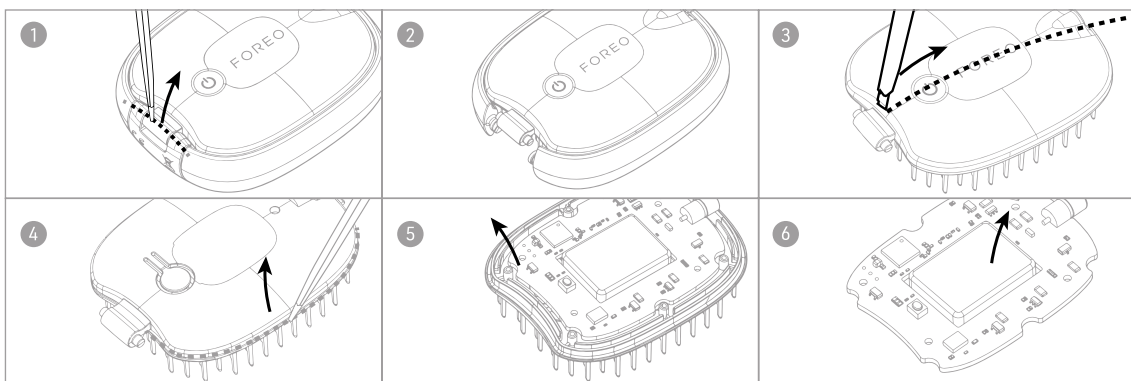

SPECIFICATIONS

MATERIALS: Body-safe silicone, PC + ABS plastic, TPEE

COLOR: Lavender

SIZE: H88 x W72 x D22 mm

PRODUCT WEIGHT: 65 g

BATTERY: Li-ion 300 mAh 3.7V

USES PER CHARGE: Up to 2 hours of use per 1 hour charge

STANDBY: 90 days

DISCLAIMER: Users of this device do so at their own risk. Neither FOREO nor its retailers assume any responsibility or liability for any injuries or damages, physical or otherwise, resulting directly or indirectly from the use of this device. Furthermore, FOREO reserves the right to revise this publication and to make changes from time to time in the contents thereof without obligation to notify any person of such revision or changes.

CAUTION: Changes or modifications to this unit not expressly approved by the party responsible for compliance could void the user's authority to operate the equipment.

FCC Statement: This device complies with Part 15 of the FCC Rules. Operation is subject to the following two conditions:
(1) This device may not cause harmful interference, and
(2) This device must accept any interference received, including interference that may cause undesired operation.

IC Statement: This device contains licence-exempt transmitter(s)/receiver(s) that comply with Innovation, Science and Economic Development Canada's licence-exempt RSS(s). Operation is subject to the following two conditions:
(1) This device may not cause interference.
(2) This device must accept any interference, including interference that may cause undesired operation of the device.

Model may be changed for improvements without notice.

FOREO declares that this device is in compliance with Directive 2014/53/EU. The full text of the EU declaration of conformity for the product is available at www.foreo.com/support/eu-conformity.

Additional legal and regulatory information is available on the app. To view, simply follow the steps below:

Step 1: Open the FOREO app & select the profile icon.

Step 2: Select 'Legal & Regulatory'.

Step 3: Select your device.

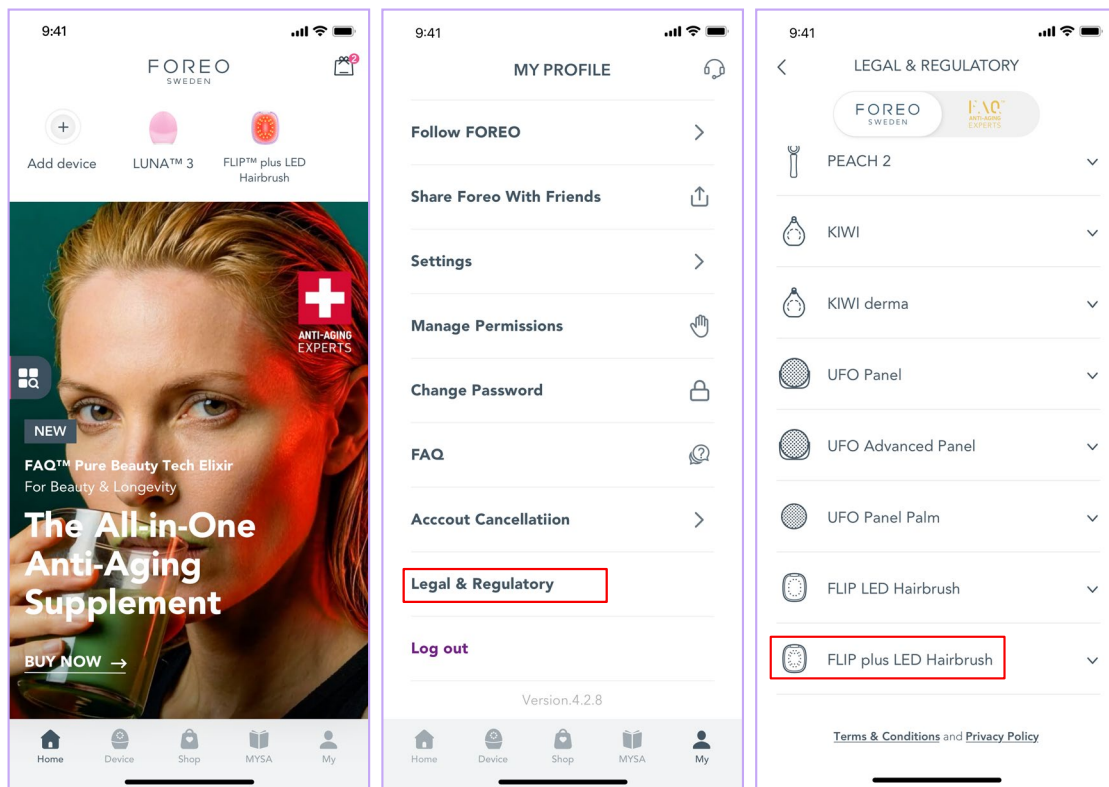

©2026 FOREO AB. ALL RIGHTS RESERVED. MANUFACTURED FOR FOREO AB.
EU IMP & RP: FAQ EUROPE D.O.O., RADNICKA CESTA 202, 10 000, ZAGREB, CROATIA.
US DISTR.: FOREO INC., 1525 E PAMA LANE, LAS VEGAS, NV 89119, USA.
AUS DISTR.: FOREO AUS., 6 PROHASKY STREET, PORT MELBOURNE, VIC, 3207 AUSTRALIA.
UK RP: FOREO LTD., LAWFORD HOUSE, ALBERT PLACE, N3 1QA LONDON.

WWW.FOREO.COM