

FOREO  
SWEDEN



UFO™

LED LIGHTHOUSE PANEL *Palm-size*



ONLINE MANUAL

# FULL USER MANUAL

## GETTING STARTED

Congratulations on taking the first step into a new era of skincare with UFO™ LED Lighthouse Panel Palm-Size. Before you begin to enjoy all the benefits of professional beauty-tech in the comfort of your home, please take a few moments to carefully read the instructions in this manual.

Please READ ALL INSTRUCTIONS BEFORE USE and utilize this product only for its intended use as described in this manual.

**⚠ WARNING:** NO MODIFICATION OF THIS EQUIPMENT IS ALLOWED.

## UFO™ LED LIGHTHOUSE PANEL Palm-Size OVERVIEW

Your favorite high-intensity LED panel - redesigned in an ultra-compact form that fits in your palm.

Inspired by the focused intensity of a lighthouse beam, precision-engineered Fresnel lenses concentrate 32 powerful LEDs into a targeted stream of light that reaches as far as 2 meters away.

With red and blue LED wavelengths to address multiple skin concerns, and up to 45 minutes of cordless use per USB charge, it delivers the same uncompromising performance - whether you're at home or on-the-go.

## GETTING TO KNOW UFO™ LED LIGHTHOUSE PANEL Palm-Size

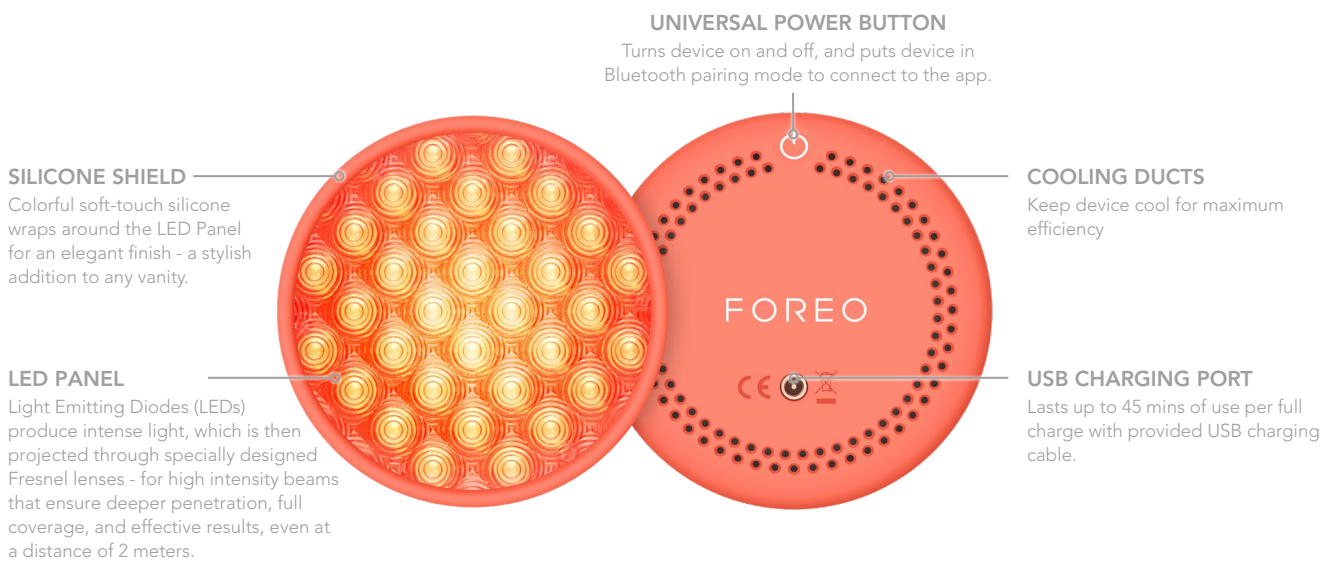

## HOW TO USE UFO™ LED LIGHTHOUSE PANEL Palm-Size

### UNLOCK YOUR DEVICE

Before using your device for the first time, you must unlock it. You can do this automatically by registering your device via the FOREO app for the first time. Simply follow the steps below:

1. Download the FOREO For You app on your mobile phone by scanning the QR code.
2. Log in to your existing account, or sign up for a new one.
3. Add device (on the top of your screen).
4. Choose the device series.
5. Follow the instructions on the app and fill in the purchase information.

And your device is ready to use!



## LIGHT SENSITIVITY TEST

Before your first session, perform this quick Light Sensitivity Test to ensure safe use.

1. Turn on your UFO™ LED Lighthouse Panel (see detailed instructions below).
2. Position your forearm approximately 30 cm / 12 inches from the LED Panel, for 3 minutes.
3. After 3 minutes, check the area on your forearm. If redness appears and lasts more than 2 hours, your skin is light-sensitive. Discontinue use, and contact your physician. Otherwise, continue your treatment as normal.

## HOW TO USE

**Prep:** To accelerate your results, apply UFO™ LED Light Serum onto the areas you wish to treat, and gently massage until fully absorbed, before starting your LED treatment.



### 1. TURN ON

Position your LED panel between 30 cm to 2 meters away from you. Then press the universal power button to turn on the LED Panel.



### 2. SELECT LIGHT

Press the button again to switch between LED colors. Access more settings and pre-set treatments via the FOREO app.



### 3. REJUVENATE

Sit back, and enjoy the numerous wellness benefits of LED light therapy for up to 15 mins. Once finished, press and hold the universal power button to turn your device off.

**Recommended usage:** 5-15 mins, 3-5 times per week.

### NOTE:

- Do not place the device directly on skin. Always maintain a minimum distance of 30 cm between the device and your skin during use.
- Do not stare directly at the LED panel or LED lights when the device is switched on.

## WARNINGS

### FOR OPTIMUM SAFETY:

- Treatments with UFO™ LED Lighthouse Panels should be comfortable. If you experience any discomfort, prolonged skin redness, or temporary changes in skin color (lightening or darkening), discontinue use immediately and consult a physician.
- Do not use the device if you have a known sensitivity to sunlight (photosensitivity) or are taking medication that makes the skin more sensitive and causes photosensitivity, e.g., Retin A, Accutane and/or other topical retinoids. Always check the instruction leaflet that comes with your medicinal product to see if photosensitivity is listed as a side effect, and seek medical advice prior to use of the device as use may harm the skin.
- This device is not intended for the treatment of medical conditions.
- Consult your doctor or dermatologist before using the device over any suspicious or cancerous lesions.
- Do not use the device if you have sunburnt or inflamed skin, or have any other form of injured or damaged skin, such as chapped skin and open trauma, wound ulceration, post-operative wounds, skin diseases, skin allergies (such as severe acne or skin infections etc.).
- Not recommended for people with a weak immune system.
- Do not use the device if you have any skin condition in the treatment area, including psoriasis, vitiligo, eczema, herpes simplex or active infections or wounds.
- Do not use the device if you have any existing medical conditions such as epilepsy, a hemorrhagic disease, cancer, tumors, or perceptual disturbance.

- Blue light may cause temporary hyperpigmentation on darker skin tones. Skin type III and above may be affected. Discontinue use if hyperpigmentation occurs. Red light is suitable for all skin tones and can help improve the appearance of hyperpigmentation, as well as redness, surface scarring, and inflammation.
- Blue light should be avoided if a person has active pigmentation issues or very sensitive skin.
- This device should not be used by children under 18 years of age, pregnant or nursing women without consulting a physician.
- Do not use the device immediately after shaving.
- Depending on an individual's skin condition, the device may cause skin irritation. If irritation persists, consult a doctor.
- Consult a doctor before use if you have a thyroid-related disease or are under treatment.
- If you have recently had a laser treatment, chemical peel, fillers, botox, or cosmetic surgery, wait at least 30 days and consult your physician before use.
- If you have a skin condition or any medical concerns, consult your physician before use.
- Do not stare directly at the LED panel or LED lights when the device is switched on. Excessive exposure to LED light can cause eye damage.
- Do not place the device directly on skin. Always maintain a minimum distance of 30 cm between the device and your skin during use.
- There may be a perception of flashing lights during the use of your device, resulting from the stimulation of your optic nerve. If you notice this condition constantly without the use of your device, consult your physician.
- Do not exceed the usage specified in the treatment regime. Damage of the skin may occur after prolonged or repeated application on one site.
- Children or persons with reduced physical, sensory or mental capabilities should not use, play with, maintain or clean the device.
- Avoid leaving the device in direct sunlight and never expose it to extreme heat or boiling water.
- Discontinue use if the device or power cable is not working properly or appears damaged in any way.
- Do not use the device if it is overheating or you suspect that it is malfunctioning.
- Discontinue use if the device or charging cable is not working properly or appears damaged in any way. Use the USB charging cable supplied with your device only.
- This device should only be used with a SELV power adapter. It is recommended that IEC60950 standard power suppliers are used to charge the device.
- Before charging, make sure that the device and charging port are completely dry. Failure to do so may result in electric shock, short circuit, or fire.
- Do not use or clean the device while charging.
- Do not use if the device has been submerged in water, and do not use with wet hands.
- Do not leave the device unattended when switched on (risk of fire or burns).
- Do not tamper or attempt to disassemble the product as this may cause damage to the unit.
- Do not use while driving or operating heavy machinery.
- Do not insert any object into any opening of the device.
- The device contains no serviceable parts.
- Use this device only for its intended use as described in this manual. Any harmful consequences resulting from misuse, connection to improper voltage sources, or any other improper applications are not the responsibility of FOREO.
- If you do not find the answer to your specific question, or if you have any other questions regarding the device's operation, please visit [foreo.com/support](https://foreo.com/support)

## CLEANING YOUR UFO™ LED LIGHTHOUSE PANEL Palm-Size

When the device surface gets dirty, use a damp lint-free cloth or towel to thoroughly wipe. We recommend doing this at least once per week.

**NOTE:** This product is not 100% waterproof, so do not wash it under running water. Be careful to avoid getting water in any openings in the device or on the stand. Never use cleaning products containing alcohol, petrol or acetone.

## TROUBLESHOOTING

Precautions to be taken in the event of changes in the performance of your UFO™ LED Lighthouse Panel:

If the LED Panel cannot be switched on/off, and the universal button does not respond:

- Battery is empty. Recharge using the USB charging cable for up to 1 hour until fully charged, and then restart your device by pressing the universal button.
- Microprocessor is temporarily malfunctioning. Press and hold the universal button to restart the device.
- If this is your first time using the LED Panel, it's locked. Follow the 'Unlock Your Device' instructions under the How To Use section of this manual.

If the LED Panel won't sync to the FOREO app:

- Ensure that the LED Panel is fully charged, and that your Bluetooth is turned on.
- Switch your Bluetooth off and then on again to try reconnecting.
- Close the FOREO app and then reopen it to restart the process.
- The app may need to be updated. Delete and reinstall the app, then make sure to restart your phone.
- Delete your phone's cookies and cache memory.

## WARRANTY TERMS & CONDITIONS

### REGISTER WARRANTY

To activate your 2-Year Limited Warranty, register through the FOREO For You app, or visit [foreo.com/product-registration](https://foreo.com/product-registration) for more information.

### 2-YEAR LIMITED WARRANTY

FOREO warrants this device for a period of TWO (2) YEARS after the original date of purchase against defects due to faulty workmanship or materials arising from Normal Use of the device. The warranty covers working parts that affect the function of the device. It does NOT cover cosmetic deterioration caused by fair wear and tear, or damage caused by accident, misuse or neglect. Any attempt to open or take apart the device (or its accessories) will void the warranty.

If you discover a defect and notify FOREO during the warranty period, FOREO will, at its discretion, replace the device free of charge. Claims under warranty must be supported by reasonable evidence that the date of the claim is within the warranty period. To validate your warranty, please keep your original purchase receipt together with these warranty conditions for the duration of the warranty period.

To claim your warranty, you must log in to your account at [www.foreo.com](https://www.foreo.com) and then select the option to make a warranty claim. Shipping costs are nonrefundable. This undertaking is in addition to your statutory rights as a consumer and does not affect those rights in any way.

## DISPOSAL INFORMATION

Disposal of old electronic equipment (applicable in the EU and other European countries with separate waste collection systems).



This device should not be treated as household waste, but rather be brought to the appropriate collection point for recycling of electrical and electronic equipment. By ensuring this device is disposed of correctly, you will help prevent the potential negative consequences for the environment and human health which could be caused by inappropriate waste handling of the device. The recycling of materials will also help conserve natural resources.

For more information about the recycling of your device, please contact your local household waste disposal service or your place of purchase.

## BATTERY REMOVAL

**NOTE:** This process is not reversible. This action must only be undertaken when the device is ready to be disposed of.

Because this device contains a lithium-ion battery, the battery must be removed before disposal and should not be thrown away with household waste. In order to do this, remove the silicone outer layer, open the inner plastic shell, remove the battery, and dispose of it in accordance with your local environmental regulations. Wear gloves during this process for your safety. Detailed visual instructions are provided below:

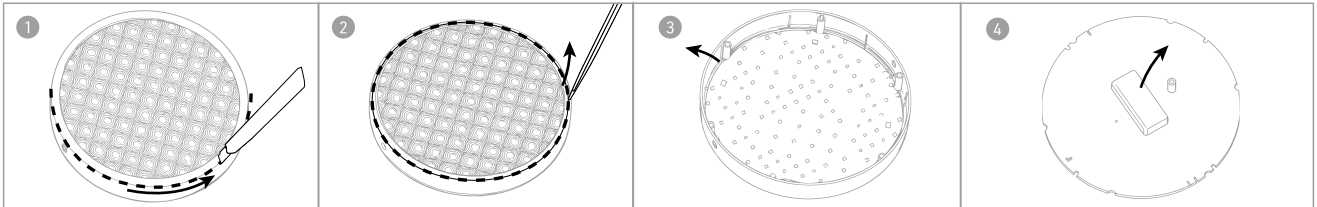

## SPECIFICATIONS

**MATERIALS:** Body-safe silicone, PC + ABS plastic

**COLOR:** Peach of Cake! / I Lilac You!

**SIZE:** H90 x W90 x D26 mm

**PRODUCT WEIGHT:** 103 g

**PRODUCT & PACKAGING WEIGHT:** 154 g

**BATTERY:** Li-ion 520 mAh 3.7V

**USES PER CHARGE:** Up to 45 mins of use per 1 hour charge

**STANDBY:** 90 days

**DISCLAIMER:** Users of this device do so at their own risk. Neither FOREO nor its retailers assume any responsibility or liability for any injuries or damages, physical or otherwise, resulting directly or indirectly from the use of this device. Furthermore, FOREO reserves the right to revise this publication and to make changes from time to time in the contents thereof without obligation to notify any person of such revision or changes.

**CAUTION:** Changes or modifications to this unit not expressly approved by the party responsible for compliance could void the user's authority to operate the equipment.

**FCC Statement:** This device complies with Part 15 of the FCC Rules. Operation is subject to the following two conditions:

- (1) This device may not cause harmful interference, and
- (2) This device must accept any interference received, including interference that may cause undesired operation.

**IC Statement:** This device contains licence-exempt transmitter(s)/receiver(s) that comply with Innovation, Science and Economic Development Canada's licence-exempt RSS(s). Operation is subject to the following two conditions:

- (1) This device may not cause interference.
- (2) This device must accept any interference, including interference that may cause undesired operation of the device.

Model may be changed for improvements without notice.

FOREO declares that this device is in compliance with Directive 2014/53/EU. The full text of the EU declaration of conformity for the product is available at [www.foreo.com/support/eu-conformity](http://www.foreo.com/support/eu-conformity).

Additional legal and regulatory information is available on the app. To view, simply follow the steps below:

Step 1: Open the FOREO app & select the profile icon.

Step 2: Select 'Legal & Regulatory'.

Step 3: Select your device.

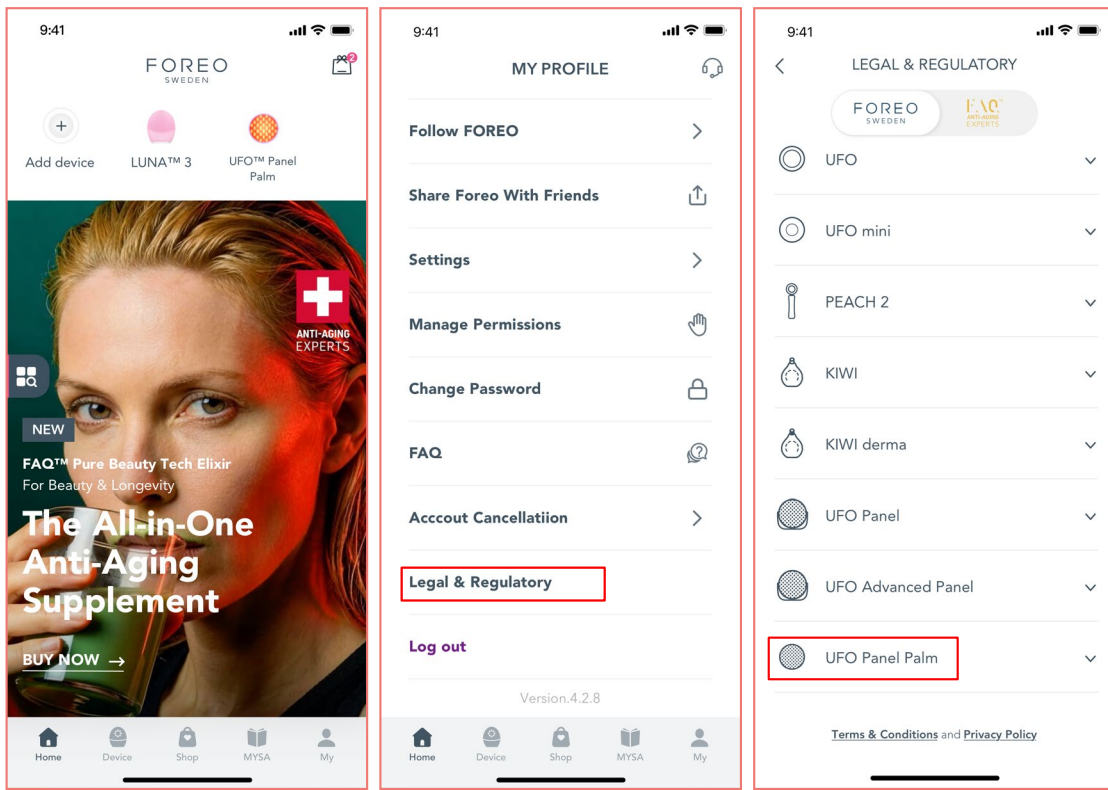

©2026 FOREO. ALL RIGHTS RESERVED / TOUS DROITS RÉSERVÉS.

MANUFACTURED FOR / FABRIQUÉ POUR: FOREO.

EU IMP. & RP.: FAQ EUROPE D.O.O., RADNICKA CESTA 202, 10000 ZAGREB, CROATIA

US DISTR.: FOREO INC., 1525 E PAMA LANE, LAS VEGAS, NV 89119, USA.

AUS DISTR.: FOREO AUS., 6 PROHASKY STREET, PORT MELBOURNE, VIC, 3207 AUSTRALIA.

UK RP: FOREO LTD., LAWFORF HOUSE, ALBERT PLACE, N3 1QA LONDON.

MANUFACTURED BY / FABRIQUÉ PAR : VIS (SHANGHAI) TECHNOLOGY CO. LTD., NO.58 LINSHENG ROAD, TINGLIN TOWN, JINSHAN DISTRICT, SHANGHAI, CHINA, 201505.

[WWW.FOREO.COM](http://WWW.FOREO.COM)